

TECHNICAL DATA SHEET

LFALC IP20 / Aga-Led® Type B

VERSION - 10.03.2015

STANDARD LUMINAIRE

Reference	LFALC
Protection Class	IP20
Lighting Source	Aga-Led® Type B
Connector	4 Positions
Size - mm	13x23
Length on measure	110mm to 3000mm
Nb Lighting Source	18 LED/m
Voltage	24V
Power	21.60 W/m
Connecting Cable	1m standard cable 2x1.5mm ²



FINISH

Color Finishing Profil

Standard	Natural Anodised Aluminium
On request	Thermo-enameling Power Coating RAL Color Anodising Chromium or Gold plating

LFALC / AGA-LED® TYPE B - 4 Positions

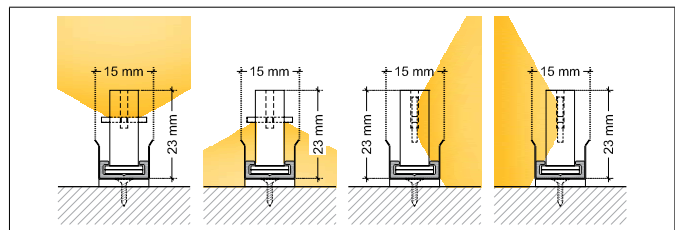
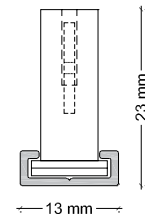

ON REQUEST

Fixation	BFA (Width: +12mm) FCP (Width: +2mm / Ht: +0.2mm) FCP-S (Width: +2mm / Ht: +2.2mm)
Dimmable	YES (1-10V, Dali, DMX, KNX) <i>Ask technical departement for more information</i>

LIGHTING SOURCE

Lighting Source	Aga-Led® Type B - Generation 2			
Ref	B2	B3	B4	B6
Voltage	24V	24V	24V	24V
Power	1.2W	0.96W	1.2W	1.2W
Beam Angle	120°	120°	120°	120°
CRI	80	80	80	80
Light Output - lm/Unit				
2000K	40 ~ 68	40 ~ 82	46 ~ 78	70 ~ 118
2400K	48 ~ 81	58 ~ 97	55 ~ 93	83 ~ 140
2800K	68 ~ 114	82 ~ 137	66 ~ 111	99 ~ 166
4000K	68 ~ 114	82 ~ 137	66 ~ 111	99 ~ 166

LFALC + FCP-S

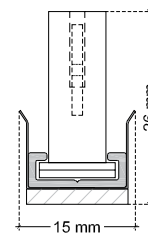

LFALC + BFA

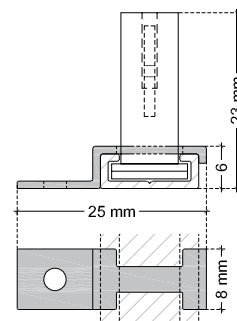

Lifetime at 25°	50'000h
L70 at 25°	36'000h
Working T°	-20°C ~ +40°C
Moisture resistant	due to conformal silicone coated

CERTIFICAT

